



### 13 Lucy Street Milton QLD

3  2  3 

Enjoy inner city Brisbane at its best from this fabulous home with easy access to Milton's classy, professional and alfresco culture. As a bonus, the city centre is only 3 kms away!

**Type** : House  
**Land Size** : 405 sqm  
**View** : <https://www.eraqld.au/7743310>

Nestled within walking distance to some of Brisbane's most popular lifestyle locations including iconic Park Road and the heart of Rosalie. Frew Park is 200 meters at the end of the street, trains and buses are conveniently located around the corner, whilst the Citycat ferry and Suncorp Stadium are also nearby.

This functional 3 bedroom home with built-in wardrobes is in the catchment area for the sought after Milton Primary School which is just a mere block away. Grab essential

[For full version visit the website](https://www.eraqld.au)

**UPPER LEVEL**



**LOWER LEVEL**

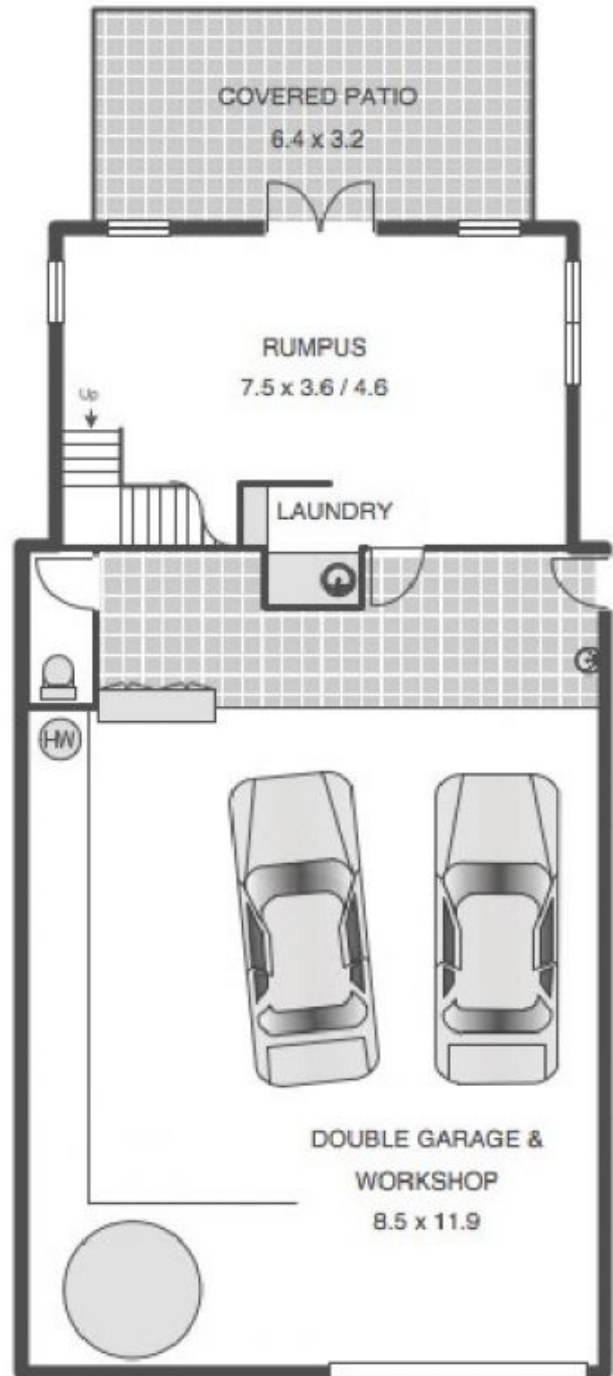

**13 LUCY ST MILTON**

APPROX INTERNAL FLOOR AREA (INC GARAGE) 283 sq m\*

APPROX FLOOR AREA INCLUDING EXTERNAL AREA 327 sq m\*

\*This figure indicates approximate usable space and may not include area of walls and therefore may differ from building or council plans.

While every attempt is made to ensure accuracy please note that these plans are only designed to give an approximate indication of layout. All dimensions, scales, angles, location or orientation of doors, walls, windows or any other items is approximate. These plans are for representation purposes only and should not be relied upon for any purpose. No responsibility is taken for any error or mis-statement within this plan.